

# HMS INDUSTRIES

27995 Ranney Parkway • Westlake, Ohio 44145

Phone 440-899-0001 • Toll-free 800-522-7127 • Fax 440-899-2661 • Email [info@hms-ind.com](mailto:info@hms-ind.com) • Web [hms-ind.com](http://hms-ind.com)

## Caged Series – Needle Bearings

Bearing No.		Bore (d)		Outer Diameter (D)		Width (B)	
caged open end SCE	caged closed end BCE	mm	in	mm	in	mm	in
SCE-2-1/2-4	-	3.9624	0.156	7.1374	0.281	6.35	0.25
SCE 44	BCE 44	6.35	0.25	11.0998	0.437	6.35	0.25
SCE 45	BCE 45	6.35	0.25	11.0998	0.437	7.9248	0.312
SCE 47	BCE 47	6.35	0.25	11.0998	0.437	11.1252	0.438
SCE 55	BCE55	7.9502	0.313	12.7	0.5	7.9248	0.312
SCE 57	BCE 57	7.9502	0.313	12.7	0.5	11.1252	0.438
SCE 59	BCE 59	7.9502	0.313	12.7	0.5	14.2748	0.562
SCE 65	BCE 65	9.525	0.375	14.3002	0.563	7.9248	0.312
SCE 66	BCE 66	9.525	0.375	14.3002	0.563	9.525	0.375
SCE 68	BCE 68	9.525	0.375	14.3002	0.563	12.7	0.5
SCE 69	BCE 69	9.525	0.375	14.3002	0.563	14.2748	0.562
SCE 610	BCE 610	9.525	0.375	14.3002	0.563	15.875	0.625
SCE 78	BCE 78	11.0998	0.437	15.875	0.625	12.7	0.5
SCE 710	BCE 710	11.0998	0.437	15.875	0.625	15.875	0.625
SCE 85	BCE 85	12.7	0.5	17.4498	0.687	7.9248	0.312
SCE 86	BCE 86	12.7	0.5	17.4498	0.687	9.525	0.375
SCE 87	BCE 87	12.7	0.5	17.4498	0.687	11.1252	0.438
SCE 88	BCE 88	12.7	0.5	17.4498	0.687	12.7	0.5
SCE 810	BCE 810	12.7	0.5	17.4498	0.687	15.875	0.625
SCE 812	BCE 812	12.7	0.5	17.4498	0.687	19.05	0.75
SCE 95	BCE 95	14.3002	0.563	19.05	0.75	7.9248	0.312
SCE 96	BCE 96	14.3002	0.563	19.05	0.75	9.525	0.375
SCE 97	BCE 97	14.3002	0.563	19.05	0.75	11.1252	0.438
SCE 98	BCE 98	14.3002	0.563	19.05	0.75	12.7	0.5
SCE 910	BCE 910	14.3002	0.563	19.05	0.75	15.875	0.625
SCE 912	BCE 912	14.3002	0.563	19.05	0.75	19.05	0.75
SCE 105	BCE 105	15.875	0.625	20.6502	0.813	7.9248	0.312
SCE 107	BCE 107	15.875	0.625	20.6502	0.813	11.1252	0.438
SCE 108	BCE 108	15.875	0.625	20.6502	0.813	12.7	0.5
SCE 1010	BCE 1010	15.875	0.625	20.6502	0.813	15.875	0.625
SCE 1012	BCE 1012	15.875	0.625	20.6502	0.813	19.05	0.75
SCE 1110	BCE 1110	17.4498	0.687	22.225	0.875	15.875	0.625
SCE 1112	BCE 1112	17.4498	0.687	22.225	0.875	19.05	0.75
SCE 126	BCE 126	19.05	0.75	25.4	1	9.525	0.375
SCE 128	BCE 128	19.05	0.75	25.4	1	12.7	0.5
SCE 1210	BCE 1210	19.05	0.75	25.4	1	15.875	0.625
SCE 1212	BCE 1212	19.05	0.75	25.4	1	19.05	0.75
SCE 136	BCE 136	20.6502	0.813	27.0002	1.063	9.525	0.375
SCE 138	BCE 138	20.6502	0.813	27.0002	1.063	12.7	0.5
SCE 1312	BCE 1312	20.6502	0.813	27.0002	1.063	19.05	0.75
SCE 1314	BCE 1314	20.6502	0.813	27.0002	1.063	22.225	0.875
SCE 146	BCE 146	22.225	0.875	28.575	1.125	9.525	0.375
SCE 148	BCE 148	22.225	0.875	28.575	1.125	12.7	0.5
SCE 1412	BCE 1412	22.225	0.875	28.575	1.125	19.05	0.75
SCE 1416	BCE 1416	22.225	0.875	28.575	1.125	25.4	1
SCE 1516	BCE 1516	23.7998	0.937	30.1498	1.187	25.4	1
SCE 167	BCE 167	25.4	1	31.75	1.25	11.1252	0.438
SCE 168	BCE 168	25.4	1	31.75	1.25	12.7	0.5
SCE 1612	BCE 1612	25.4	1	31.75	1.25	19.05	0.75
SCE 1616	BCE 1616	25.4	1	31.75	1.25	25.4	1
SCE 186	BCE 186	28.575	1.125	34.925	1.375	9.525	0.375
SCE 188	BCE 188	28.575	1.125	34.925	1.375	12.7	0.5
SCE 1812	BCE 1812	28.575	1.125	34.925	1.375	19.05	0.75
SCE 1816	BCE 1816	28.575	1.125	34.925	1.375	25.4	1
SCE 1916	BCE 1916	30.1498	1.187	38.1	1.5	25.4	1
SCE 208	BCE 208	31.75	1.25	38.1	1.5	12.7	0.5

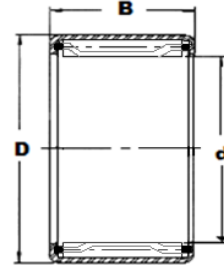

OPEN

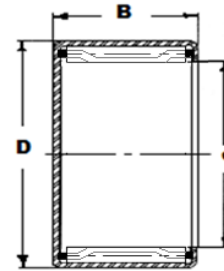

CLOSED